





6FM 65S

12V 65Ah

Specifications

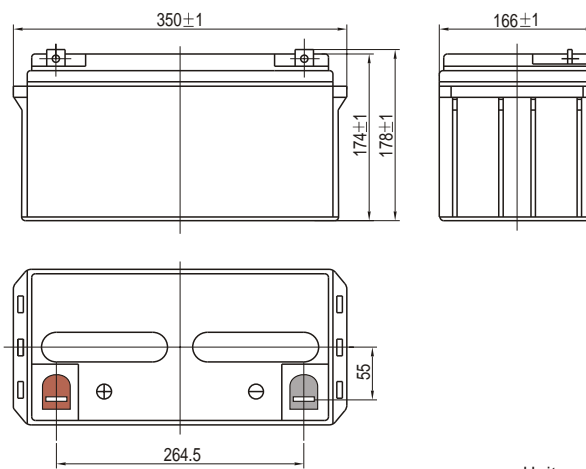
Nominal Voltage		12V
Rated Capacity (20 hour rate)		65Ah
Dimensions	Total Height (with terminals)	7.01 inches (178mm)
	Height	6.85 inches (174mm)
	Length	13.8 inches (350mm)
	Width	6.54 inches (166mm)
Weight		Approx.48.91lbs (22.2Kg)



Unit:mm

Characteristics

Capacity* 77°F(25°C)	20 hour rate (3.25A)	65Ah
	10 hour rate (6.15A)	61.5Ah
Internal Resistance	5 hour rate (12A)	60Ah
	1 hour rate (42A)	42Ah
	15 minute Rate (103A)	25.8Ah
Capacity affected by Temperature (20 hour rate)	Full charged Battery 77°F(25°C)	5.8mW
	104°F(40°C)	102%
	77°F(25°C)	100%
	32°F(0°C)	85%
Self-Discharge 68°F(20°C)	5°F(-15°C)	65%
	Capacity after 3 month storage	90%
	Capacity after 6 month storage	80%
Max. Discharge Current 77°F(25°C)	Capacity after 12 month storage	60%
	650A (5s)	
Terminal		F5
Charge (Constant Voltage)	Cycle	14.4-14.7V/77°F(25°C) Max. Current 19.5A
	Float	13.6-13.8V/77°F(25°C)

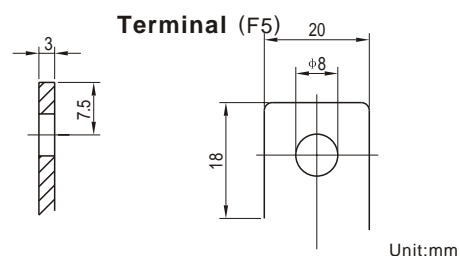

Unit:mm

Constant power discharge ratings-watts per cell at 25°C(77°F)

End Point Volts/Cell	5min	10min	15min	30min	45min	1h	2h	3h	5h
1.60V	367	242	193	123	99.2	78.3	86.3	36.2	25.6
1.65V	344	228	183	117	94.6	75.0	83.7	35.3	25.2
1.70V	321	214	172	111	89.9	71.6	80.8	34.4	24.7
1.75V	299	199	162	104	85.0	68.0	77.7	33.3	24.2
1.80V	277	185	151	97.9	80.1	64.3	74.3	32.2	23.6

*The above data are average values, and can be obtained within 3 charge/discharge cycles. These are not minimum values.

Discharge current v's time 77°F(25°C)

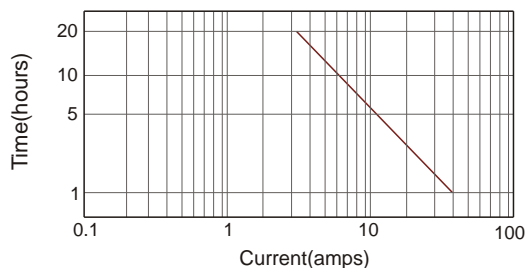

Discharge characteristic (25°C)

