

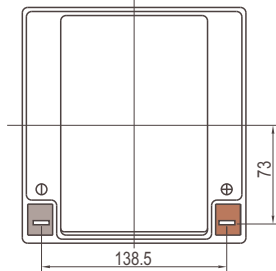

# CP12240

## 12V24Ah

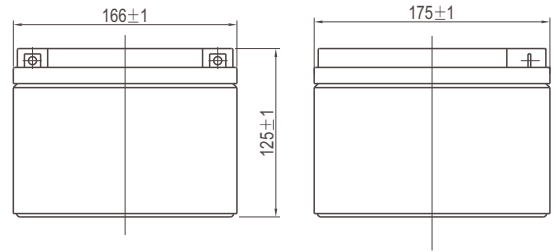

Unit:mm

### Terminal

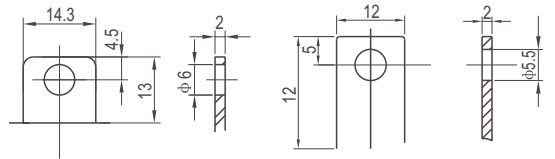

Terminal F4(Optional)

Terminal F3

Unit:mm

### Specifications

Nominal Voltage		12V
Rated Capacity (20 hour rate)		24Ah
Dimensions	Total Height (with terminals)	4.92 inches (125mm)
	Height	4.92 inches (125mm)
	Length	6.54 inches (166mm)
	Width	6.89 inches (175mm)
Weight		Approx. 19.01lbs (8.6Kg)

### Characteristics

Capacity* 77°F(25°C)	20 hour rate (1.2A)	24Ah
	10 hour rate (2.37A)	23.7Ah
	5 hour rate (4.4A)	22Ah
	1 hour rate (16A)	16Ah
	15 minute Rate (48A)	12.0Ah
Internal Resistance	Full charged Battery 77°F(25°C)	12mΩ
Capacity affected by Temperature (20 hour rate)	104°F(40°C)	102%
	77°F(25°C)	100%
	32°F(0°C)	85%
	5°F(-15°C)	65%
Self-Discharge 68°F(20°C)	Capacity after 3 month storage	90%
	Capacity after 6 month storage	80%
	Capacity after 12 month storage	60%
Max. Discharge Current 77°F(25°C)	300A (5s)	
Terminal	F3/F4	
Charge (Constant Voltage)	Cycle	14.5-14.9V/77°F(25°C) Max. Current 9.6A
	Float	13.6-13.8V/77°F(25°C)

### Discharge current v's time 77°F(25°C)

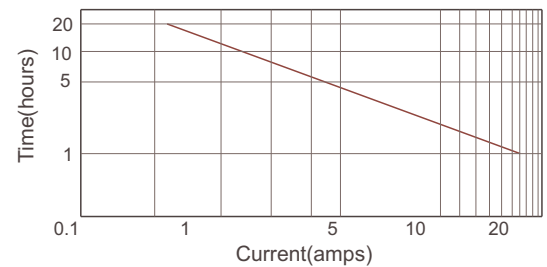

### Discharge characteristic (25°C)

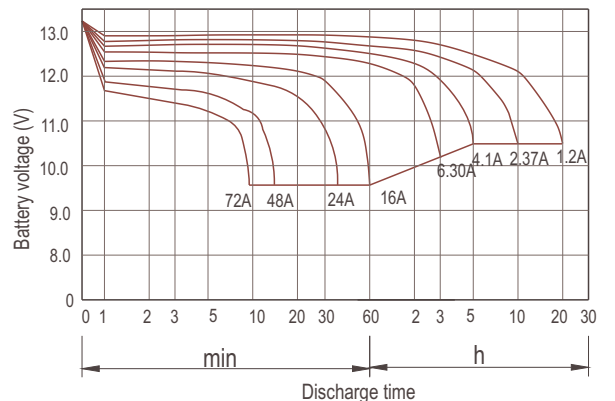

### Constant power discharge ratings-watts per cell at 25°C(77°F)

End Point Volts/Cell	5min	10min	15min	30min	45min	1h	2h	3h	5h
1.60V	185	121	90.0	55.0	40.0	31.7	19.6	13.4	8.54
1.65V	173	114	85.1	52.3	38.2	30.3	19.0	13.1	8.39
1.70V	161	107	80.2	49.4	36.3	28.9	18.3	12.5	8.22
1.75V	151	99.7	75.2	46.6	34.3	27.5	17.6	12.0	8.03
1.80V	139	92.7	70.3	43.7	32.3	26.0	16.9	11.4	7.83

\*The above data are average values, and can be obtained within 3 charge/discharge cycles. These are not minimum values.